

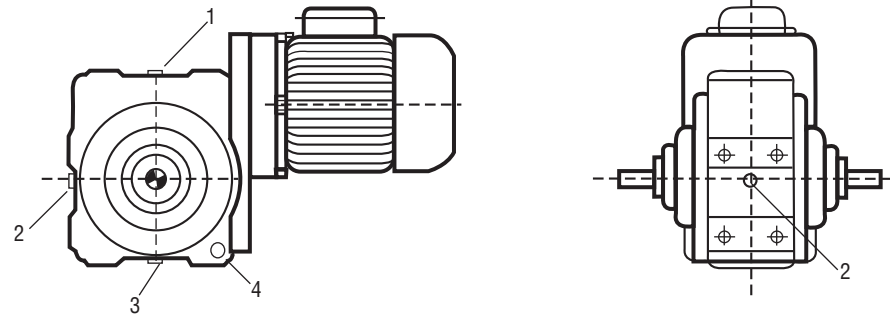

HAVALANDIRMA, BOŞALTIMA VE YAĞ KONTROL CİVATALARININ POZİSYONLARI

Sonsuz Vidalı Redüktörler

Montaj Pozisyonu	Havalandırma Cıvatası	Yağ Kontrol Cıvatası	Yağ Boşaltma Cıvatası
S1-S6-S15-S20	4	3	1
S2-S5-S16-S19	1	2	4
S3-S8-S17-S22	4	2	1
S4-S7-S18-S21	1	3	4
S9-S23	1	2	4



Sonsuz Vidalı Helis Dişlili Redüktörler

Montaj Pozisyonu	Havalandırma Cıvatası	Yağ Kontrol Cıvatası	Yağ Boşaltma Cıvatası
S1-S6-S15-S20	4 ve 6	5	1
S2-S5-S16-S19	1 ve 6	2	4 ve 5
S3-S8-S17-S22	4 ve 5	2	1 ve 6
S4-S7-S18-S21	1 ve 5	3	4 ve 6
S9-S23	1 ve 5	2 ve 3	4 ve 6

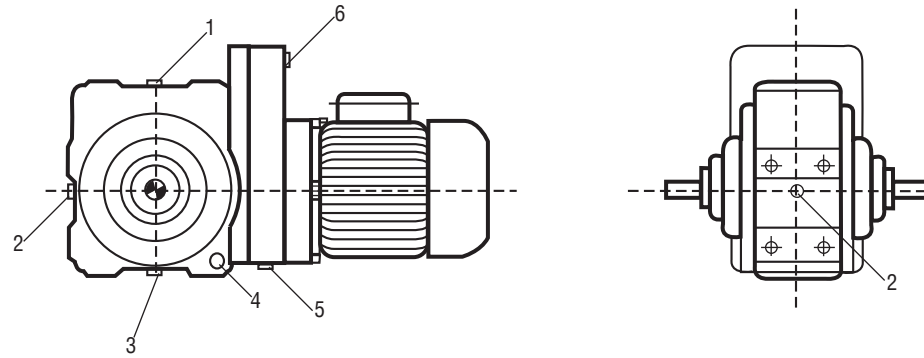

Sonsuz Vidalı Helis Dişlili Redüktörler

Montaj Pozisyonu	Havalandırma Cıvatası	Yağ Kontrol Cıvatası	Yağ Boşaltma Cıvatası
S1-S6-S15-S20	4 ve 6	5	1
S2-S5-S16-S19	1 ve 6	2	4 ve 5
S3-S8-S17-S22	4 ve 5	2	1 ve 6
S4-S7-S18-S21	1 ve 5	3	4 ve 6
S9-S23	1 ve 5	2 ve 3	4 ve 6

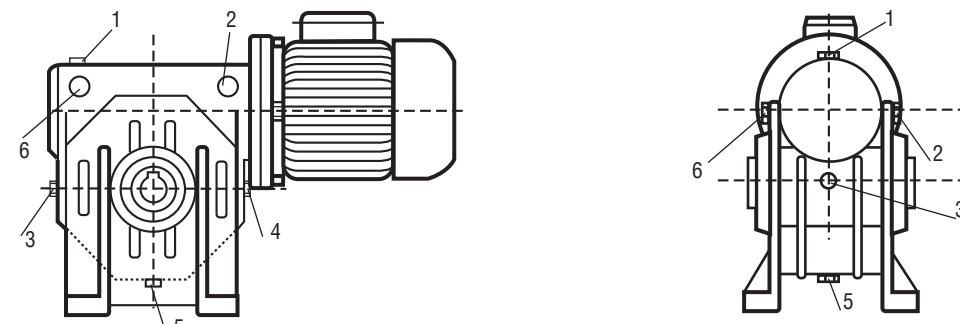

Mil, Flanş, Klemens kutusu ve çevirme moment dayamasının pozisyonları

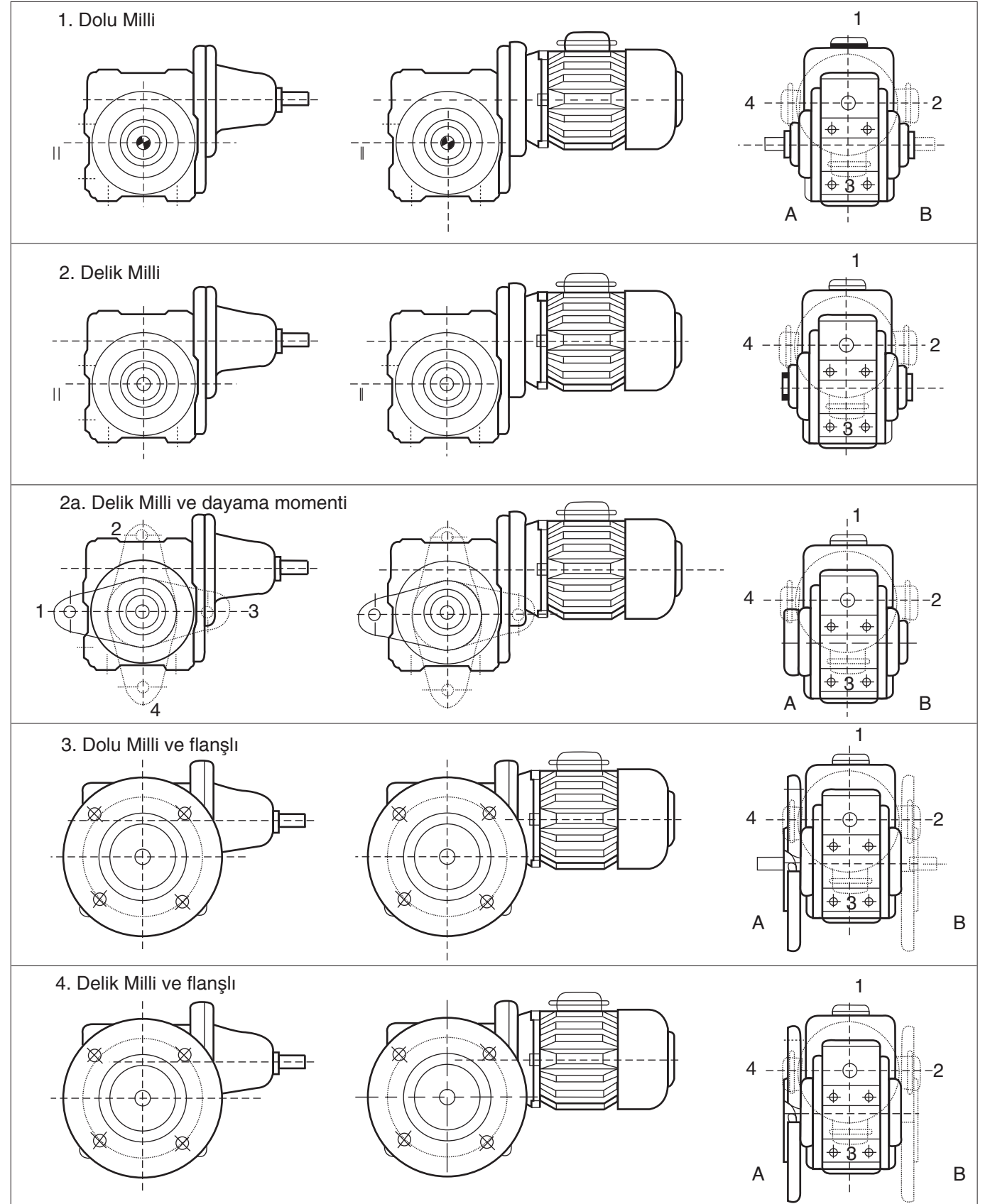

Normal Yapım Şekli 1 ve 4:

Mil A tarafında, Klemens kutusu 1'de
Flanşlı gövdelerde flanş A tarafında

GÜÇ

HP	KW	TİPİ	Çıkış Devir Sayısı 1/dk Çıkış momenti Nm.()	Ölçülendirme (sayfa)	Amper	Ağırlık (kg)
0.17	0.12	TB 530 - 63 L/6	12 15	56/57	0.64	15
			(30) (28)			
		TB 400 - 63 S/4	18 20 23 28 35 47 56 70 94		0.44	12
			(20) (25) (19) (21) (19) (15) (13) (10) (10)			
0.25	0.18	TB 530 - 71 S/6	12 15	56/57	0.90	16
			(44) (41)			
		TB 400 - 63 L/4	18 20 23 28 35 47 56 70 94		0.55	13
			(29) (32) (27) (31) (28) (24) (22) (19) (14)			
0.33	0.25	TB 652 - 71 L/6	12 14 18	56/57	1.3	22
			(58) (58) (63)			
		TB 530 - 71 S/4	19 23 28 37 47 56 70 94		0.80	16
			(20) (25) (19) (21) (19) (24) (22) (19)			
0.50	0.37	TB 652 - 71 S/6	12 14 18	56/57	1.4	25
			(88) (88) (96)			
		TB 530 - 71 L/4	19 23 28 37 47 56 70 94		1.15	17
			(56) (53) (62) (53) (47) (40) (37) (29)			
0.75	0.55	TB 652 - 80 S/6	18 21 28	56/57	1.50	25
			(88) (88) (92)			
		TB 530 - 80 S/4	37 47 56 70 93		1.50	20
			(77) (71) (59) (55) (44)			
1.0	0.75	TB 652 - 80 L/4	21 28 39 50	56/57	1.90	26
			(117) (123) (101) (89)			
		TB 530 - 80 L/4	56 67 93		1.90	21
			(81) (73) (58)			
1.5	1.1	TB 652 - 90 S/4	39 50 70 93	56/57	2.90	33
			(151) (133) (105) (80)			
2	1.5	TB 652 - 90 L/4	39 50 70 93	56/57	.3.7	37
			(151) (155) (141) (90)			

GÜÇ

HP	KW	TİPİ	Çıkış Devir Sayısı 1/dk Çıkış momenti Nm.()	Ölçülendirme (sayfa)	Amper	Ağırlık (kg)
0.17	0.12	TB 6520 - 63 L/6	1.8 2.1 2.7 3.8 4.8 5.3 6.0 6.8 7.9	56/57	0.44	23
			(100) (123) (141) (156) (160) (69) (71) (125) (75)			
		TB 5301 - 63 S/4	2.1 2.6 3.1 4.1 5.2 6.2 7.4 9 10.4		0.44	17
			(54) (61) (66) (77) (77) (76) (74) (47) (78)			
			11.5 14 16 18			
			(76) (49) (61) (43)			
		TB 4000 - 63 S/4	2.2 2.6 3.6 4.5 6.0 7.2 9.0 10.8 13		0.44	16
			(30) (32) (35) (37) (39) (32) (38) (28) (35)			
0.25	0.18	TB 6520 - 63 L/4	1.8 2.1 2.7 3.8 4.8 5.3 6.0 6.8 7.9 11	56/57	0.55	24
			(100) (123) (141) (154) (155) (101) (104) (156) (111) (130)			
		TB 5301 - 63 L/4	3.1 4.1 5.2 6.2 7.4 9.0 10.4 11.5 14 16		0.55	18
			(66) (77) (77) (76) (74) (61) (78) (76) (72) (74)			
		TB 4000 - 63 L/4	3.6 4.5 6.0 7.2 9.0 10.8 13.0 16.2 18 22		0.55	17
			(35) (37) (39) (38) (28) (35) (37) (38) (38) (39)			
0.33	0.25	TB 6520 - 71 S/4	3.8 4.8 5.3 6.0 6.8 7.9 11 14 20 22	56/57	0.8	25
			(156) (155) (101) (123) (156) (141) (152) (106) (83) (92)			
		TB 5301 - 71 S/4	4.1 5.2 6.2 7.4 9.0 10.4 11.5 14 16 18		0.8	19
			(77) (77) (76) (74) (61) (78) (76) (77) (74) (77)			
		TB 4000 - 71 S/4	6.0 7.2 9.0 10.8 13.0 16.2 18 22 26 32		0.8	18
			(39) (32) (38) (28) (35) (37) (39) (32) (32) (38)			
0.5	0.37	TB 6520 - 71 L/4	4.8 5.3 6.0 6.8 7.9 11 14 20 22 25	56/57	1.1	26
			(155) (101) (123) (156) (140) (152) (155) (125) (140) (90)			
		TB 5301 - 71 L/4	18 21.5 23 26 33 36 40 51		1.1	20
			(77) (76) (72) (74) (75) (77) (69) (49)			
		TB 4000 - 71 L/4	22 26 32 43		1.1	19
			(39) (32) (38) (36)			
0.75	0.55	TB 6520 - 80 S/4	20 22 25 31 36 40 56	56/57	1.5	29
			(156) (152) (135) (139) (104) (85) (77)			
		TB 5301 - 80 S/4	51 56 71 80		1.5	23
			(74) (77) (58) (58)			
1.0	0.75	TB 6520 - 80 L/4	22 25 31 36 40	56/57	1.9	30
			(152) (155) (152) (139) (113)			
1.5	1.1	TB 6520 - 90 S/4	40 56 64 88	56/57	2.9	37
			(155) (153) (144) (98)			

	i	n2	MdmaxNm	Kw	%
TB 400 W(T)	80	18	30	0.18	30
	70	20	32	0.16	42
	60	23	28	0.18	36
	50	28	35	0.21	49
	40	35	37	0.24	56
	30	47	39	0.30	63
	25	56	32	0.26	70
	20	70	38	0.35	77
	15	93	36	0.45	77
	10	140	38	0.68	80

Ağırlık - Gewicht - Weight : 5.5 kg

TB 530 W(T)	75	19	57	0.37	30
	60	23	60	0.41	35
	50	28	66	0.39	49
	40	37	77	0.52	56
	35	40	77	0.61	63
	30	47	77	0.59	63
	25	56	76	0.69	63
	20	67	74	0.73	70
	15	93	78	0.97	77
	13.5	104	76	1.05	77
	10	145	74	1.38	80

Ağırlık - Gewicht - Weight : 7 kg

TB 652 W(T)	80	17.5	101	0.60	30
	70	20	105	0.76	35
	60	23	108	0.80	40
	50	28	141	0.83	49
	40	35	145	0.95	53
	35	40	156	1.12	56
	30	47	155	1.26	63
	20	70	156	1.60	70

Ağırlık - Gewicht - Weight : 11 kg

	l	l1	l2	n2	MdmaxNm	Kw	%
TB 4000 W(T)	622.4	7.78	80	2.24	30	0.02	30
	544.6	7.78	70	2.57	32	0.02	42
	389.0	7.78	50	3.59	35	0.03	49
	311.0	7.78	40	4.49	37	0.03	56
	233.4	7.78	30	5.99	39	0.04	63
	194.5	7.78	25	7.19	32	0.04	70
	155.6	7.78	20	8.99	38	0.05	77
	129.6	2.16	60	10.8	28	0.09	36
	108.0	2.16	50	13.0	35	0.10	49
	86.4	2.16	40	16.2	38	0.09	80
	77.8	7.78	10	18	38	0.09	80
	64.8	2.16	30	21.6	39	0.14	63
	43.2	2.16	20	32.4	38	0.16	77

Ağırlık - Gewicht - Weight : 6.5 kg

TB 5301 W(T)	675.0	9.0	75	2.7	54	0.04	30
	540	9.0	60	2.6	61	0.05	35
	450	9.0	50	3.1	66	0.04	49
	342	9.0	40	4.1	77	0.06	56
	272	9.0	30	5.2	77	0.07	63
	225	9.0	25	6.2	76	0.05	63
	189	9.0	20	7.4	74	0.08	80
	156	2.6	40	14.2	77	0.20	56
	78	2.6	30	18	77	0.23	63
	65	2.6	25	21.5	76	0.27	63

Ağırlık - Gewicht - Weight : 9 kg

TB 6520 W(T)	824	10.3	80	1.7	101	0.06	30
	721	10.3	70	1.94	123	0.07	35
	618	10.3	60	2.26	130	0.07	40
	515	10.3	50	2.71	140	0.08	49
	412	10.3	40	3.39	145	0.09	54
	370	10.3	35	3.77	156	0.11	56
	288	10.3	30	4.85	155	0.12	69
	264	3.52	70	5.7	101	0.18	30
	211	3.52	60	6.6	123	0.25	35
	176	3.52	50	7.95	140	0.23	49
	140	3.52	40	10.1	152	0.21	63
	105.6	3.52	30	13.2	155	0.36	63
	70.4	3.52	20	19.8	156	0.46	70

Ağırlık - Gewicht - Weight : 13 kg

GÜÇ

HP	KW	TİPİ	Çıkış Devir Sayısı 1/dk Çıkış momenti Nm.()								Ölçülendirme (sayfa)	Amper	Ağırlık (kg)	
0.17	0.12	TB 32 - 63 S/4	30	35	40	50	70	82	140	56/57	0.44	6		
			(30)	(28)	(22)	(18)	(15)	(13)	(6)					
0.25	0.18	TB 32 - 63 L/4	30	35	40	50	70	82	140	56/57	0.55	6		
			(30)	(28)	(22)	(18)	(15)	(13)	(6)					
		TB 550 -63/L4	23	28	35	40	50	70	93			10		
			(39)	(32)	(40)	(32)	(27)	(20)	(17)					
		TB 950/01 -63L/4	1.8	2	2.7	3.7	4.5	5.3	5.7	7.2	8	9	11	34
			(315)	(315)	(239)	(271)	(223)	(189)	(176)	(194)	(175)	(155)	(127)	
0.33	0.25	TB 32 - 71S/4	35	40	50	70	82	140	56/57	0.8	7			
			(30)	(23)	(19)	(16)	(14)	(7)						
		TB 550 - 71S/4	23	28	35	40	50	70	93	140		16		
			(35)	(41)	(35)	(33)	(30)	(24)	(19)	(13)				
		TB 950/01 -71S/4	2.7	3.7	4.5	5.3	5.7	7.2				35		
			(315)	(306)	(294)	(250)	(232)	(256)						
		TB 110/20- 71S/4	1.7	1.9	2.7	3.7	4.4	5.3				55		
			(389)	(485)	(485)	(358)	(301)	(250)						
0.5	0.37	TB 550 -71L/4	23	28	35	40	50	70	93	140	56/57	1.1	16	
			(53)	(62)	(53)	(50)	(43)	(38)	(29)	(19)				
		TB 750 -71L/4	20	23	28							23		
			(56)	(53)	(62)									
		TB 950/01 -71L/4	5.3	5.7	7.2	8	9	11				36		
			(315)	(315)	(315)	(306)	(306)	(254)						
		TB 110/20 -71L/4	1.9	2.7	3.7	4.4	5.3	6				56		
			(490)	(371)	(271)	(228)	(189)	(164)						
0.75	0.55	TB 550 -80S/4	35	40	50	70	93	140	56/57	1.5	18			
			(77)	(73)	(70)	(53)	(44)	(29)						
		TB 750 -80S/4	20	23	28							26		
			(88)	(88)	(92)									
		TB950 -80S/4	17	20	23							38		
			(250)	(210)	(190)									
		TB 950/01 -80S/4	11	12.5	13.4	14.3	15.3	16.7	17.9			40		
			(273)	(241)	(224)	(210)	(197)	(250)	(234)					
		TB 110/20 -80S/4	5.3	6	7.6	8	8.9	9.7	12.2			58		
			(284)	(251)	(396)	(376)	(338)	(388)	(388)					
		TB 130/30-80S/4	2.8	3.7	4.7	5.5	6.2	7				75		
			(536)	(466)	(320)	(274)	(312)	(429)						
1	0.75	TB 550 -80L/4	50	63	70	93	140	56/57	1.9	19				
			(85)	(75)	(69)	(58)	(39)							
		TB 750 -80L/4	23	28	35	40	50	70	93			28		
			(115)	(123)	(111)	(101)	(89)	(73)	(58)					
		TB 950 -80L/4	20	23	28							33		
			(170)	(160)	(150)									
		TB 110 -90S/6	9	11	14	18					2.3	42		
			(228)	(195)	(180)	(170)								
		TB110/20 -80L/4	8	8.9	9.7	12.2	14.3					59		
			(485)	(450)	(414)	(328)	(280)							
		TB 130/30 -80L/4	3.7	4.7	5.5	6.2	7	8.2	8.9			76		
			(541)	(426)	(365)	(323)	(286)	(401)	(450)					

GÜÇ

HP	KW	TIPI	Çıkış Devir Sayısı 1/dk Çıkış momenti Nm.()				Öçülendirme (sayfa)	Amper	Ağırlık (kg)					
1.5	1.1	TB 750 -90S/4	40	50	70	93	56/60	2.9	33					
			(151)	(153)	(105)	(92)								
			23	28	35	40								
			(168)	(188)	(172)	(170)								
TB 950 -90S/4	12.2	14	16	18	19	21	66	66						
			(482)	(411)	(410)	(400)			(381)	(350)				
			8.2	9	11	12.6			15					
			(461)	(424)	(343)	(466)			(493)					
TB 110/20 -90S/4	5	6	7	8	9.1	109	109	109						
			(900)	(900)	(840)				(726)	(612)				
			2	1.5	TB 750 -90L/4				50	70	93	56/60	3.7	37
			(155)	(140)	(110)				56/60	3.7	37			
TB 950 -90L/4	35	40	50	50										
(229)	(210)	(190)	56/60	3.7	37									
TB 110 -90L/4	23	28				35	53							
(224)	(250)	(250)				56/60	3.7	37						
TB 130 -90L/4	14	18							23	66				
(286)	(239)	(200)	56/60	3.7	37									
TB 1050/30 -90L/4	7	8.1							9.6	11	112			
(880)	(840)	(700)				(640)	56/60	3.7	37					
3	2.2	TB 950 -100L/4				70				93	56/60	5.4	53	
(236)	(180)	56/60	5.4	53										
TB 110 -100L/4	35				50	56				56				
(344)	(294)				(268)	56/60	5.4	53						
TB 130 -100L/4	23				28				69					
(336)	(376)	56/60	5.4	53										
TB 1050 -100L/4	18				23				100					
(358)	(336)				56/60	5.4	53							
4	3							TB 950 -100L/40	93	56/60	7.4	58		
(246)	56/60	7.4	58											
TB 110 -100L/40				50				70	93	61				
(370)				(358)	(315)	56/60	7.4	58						
TB 130 -100L/40				35	40				50	74				
(458)	(410)	(390)	56/60	7.4	58									
TB 1050 -100L/4	23	28							105					
(448)	(501)	56/60				7.4	58							
5.5	4							TB 110 -112M/4	93	56/60	9	72		
(330)	56/60		9	72										
TB 130 -112M/4					50			70	93	85				
(505)		(433)			(350)	56/60	9	72						
TB 1050 -112M/4		35			40				116					
(630)	(593)	56/60	9	72										
7.5	5.5				TB 130 -132S/4				93	56/60	12	104		
(450)	56/60				12	104								
TB 1050 -132S/4							50	70	93	135				
(690)		(590)	(500)	56/60			12	104						
10		7.5	TB 1050 -132M/4						93	56/60	15.6	146		
(601)	56/60	15.6	146											

	i	n2	MdmaxNm	Kw	%
TB 550 W(T)	50	28	66	0.39	49
	40	35	77	0.52	56
	30	47	77	0.59	63
	25	56	76	0.69	70
	20	70	74	0.73	77
	15	93	78	0.97	77
	10	140	74	1.38	80
Ağırlık - Gewicht - Weight : 5.5 kg					
TB 750 W(T)	70	19	101	0.60	30
	60	23	120	0.70	35
	50	28	141	0.83	49
	40	37	156	0.90	56
	35	40	156	1.12	63
	30	47	156	1.26	63
	25	56	152	1.32	63
	20	67	150	1.60	70
	15	93	145	2.17	77
	13.5	104	145	2.20	77
	10	145	135	3.0	80
Ağırlık - Gewicht - Weight : 13 kg					
TB 950 W(T)	80	17.5	264	0.75	30
	70	20	295	0.90	35
	60	23	315	1.09	36
	50	28	276	1.10	49
	40	35	306	1.46	56
	35	40	265	1.45	58
	30	47	242	1.44	63
	25	56	211	1.46	70
	20	70	257	2.19	70
	15	93	264	2.93	78
Ağırlık - Gewicht - Weight : 23 kg					
TB 110 W(T)	60	23	445	1.45	36
	50	28	381	1.46	49
	40	35	485	2.20	56
	30	46	373	2.17	63
	15	93	365	4.01	78
Ağırlık - Gewicht - Weight : 37 kg					
TB 130 W(T)	80	17.5	565	1.51	30
	70	20	610	1.70	35
	60	23	673	2.18	36
	50	28	571	2.18	49
	40	35	650	2.95	56
	35	40	690	2.95	58
	30	47	503	2.89	63
	20	70	480	4.06	77
	15	93	500	5.49	79
Ağırlık - Gewicht - Weight : 50 kg					
TB 1050 W(T)	80	17.5	860	2.27	30
	70	20	890	2.45	35
	60	23	910	2.90	36
	50	28	777	2.94	49
	40	35	900	4.04	56
	35	40	800	4.10	58
	30	47	701	3.99	63
	15	93	675	7.33	78

Ağırlık - Gewicht - Weight : 75 kg

	l	l1	l2	n2	MdmaxNm	Kw	%
TB 950/01 W(T)	780	13.0	60	1.79	315	0.09	36
	696	11.6	60	2.01	315	0.10	36
	510	8.5	60	2.74	315	0.13	36
	376	9.4	40	3.72	306	0.16	56
	312	7.8	40	4.48	306	0.19	56
	270	4.5	60	5.18	315	0.25	36
	235.8	3.92	60	5.93	315	0.28	36
	199	3.32	60	7.02	315	0.33	36
	157	3.93	40	8.9	306	0.37	56
	113.2	2.83	40	12.4	306	0.52	56
	97.6	2.44	40	14.3	306	0.60	56
	84	5.6	15	16.7	264	0.53	78
	72	4.8	15	19.4	264	0.61	78
	59	3.93	15	23.7	264	0.75	78
Ağırlık - Gewicht - Weight : 33 kg							
TB 110/20 W(T)	828	13.8	60	1.69	490	0.14	28
	508	8.48	60	2.75	490	0.19	28
	376	6.27	60	3.72	490	0.29	28
	258	4.30	60	5.42	490	0.41	28
	200.8	2.02	40	6.97	485	0.49	56
	184.4	4.61	40	7.59	485	0.53	56
	151.2	3.78	40	9.25	485	0.58	56
	98.4	2.46	40	14.2	485	0.9	56
	87	2.9	30	16.2	427	0.92	70
	73.8	2.46	30	19.3	427	1.01	70
Ağırlık - Gewicht - Weight : 52 kg							
TB 130/30 W(T)	492.5	9.85	50	2.8	660	0.29	28
	395	7.9	50	3.72	660	0.39	28
	280	7.0	40	4.60	660	0.49	28
	226	5.65	40	6.33	660	0.66	28
	169.5	5.65	30	8.48	673	0.8	36
	118.8	3.96	30	9.15	673	0.87	36
	94	3.13	30	14.8	590	1.07	70
	89.4	2.98	30	17.4	590	1.25	70
Ağırlık - Gewicht - Weight : 71 kg							
TB1050/30W(T)	280	7.0	40	5.0	900	0.58	56
	226.0	5.65	40	6.2	900	0.72	56
	200.8	5.02	40	7.0	900	0.81	56
	172.0	4.3	40	8.1	900	0.94	56
	146.4	3.66	40	9.6	900	1.11	56
	126	3.15	40	11.1	900	1.28	56
	109.8	3.66	30	13.0	824	1.28	70
	101.7	3.39	30	13.76	824	1.51	70
	89.40	2.98	30	15.65	824	1.75	70
Ağırlık - Gewicht - Weight : 98 kg							

Flanş merkezleme \varnothing 230 mm'ye kadar ISO J6,
230 mm'den büyüklerde ISO h6

Flanschzentrier - \varnothing bis 230 mm nach ISO J6,
über 230 mm nach ISO h6

Flange centering dia. up to 230 mm ISO J6,
over 230 mm: ISO h6

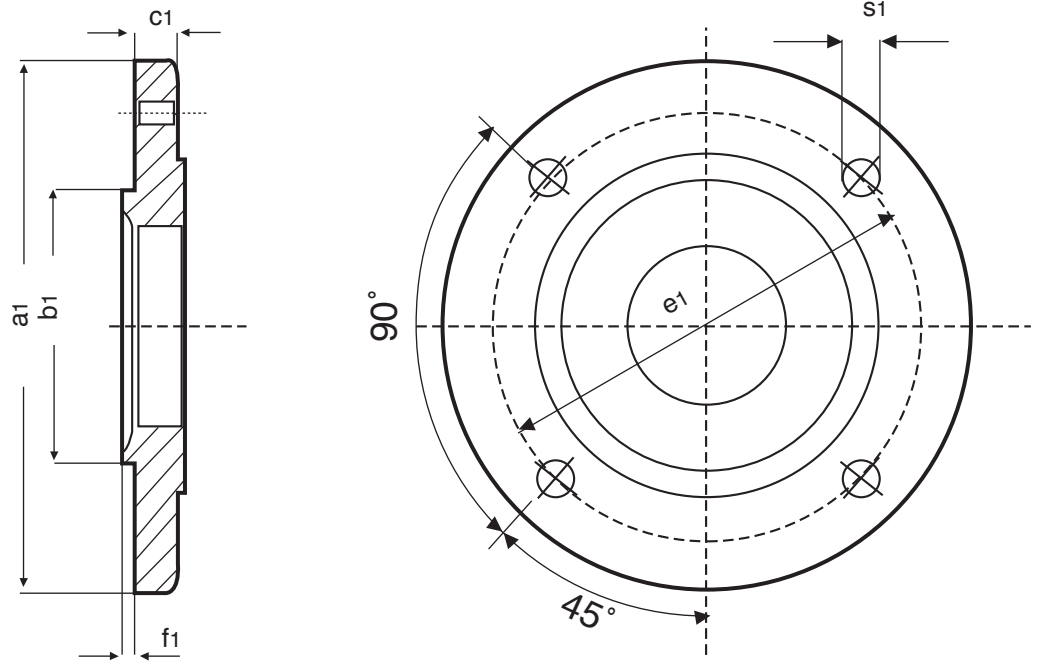

TİPİ	a1	b1	c1	e1	f1	s1
TB 400-4000	(120)	80	10	100	3	7
TB 530-5301	(140)	95	10	115	3	9
TB 652-6520	(160)	110	10	130	3.5	9

SONSUZ V-DALI MOTORLU REDÜKTÖRLER

**SCHNECKENGETRIEBEMOTOREN
WORM GEARED MOTORS**

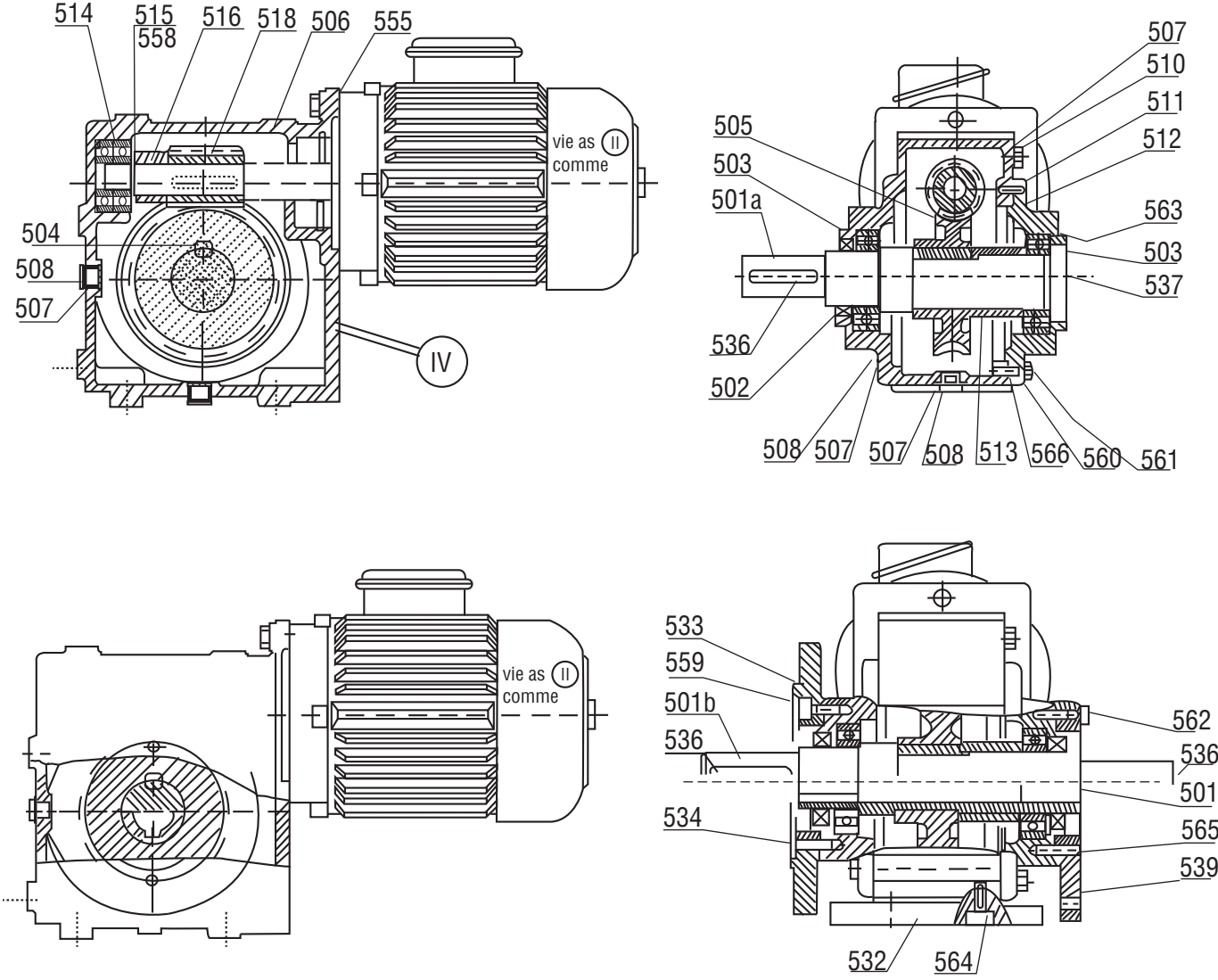

SONSUZ VİDALI W(T) TİPİ REDÜKTÖR

**SCHNECKENGETRIEBE MIT FREIER ANTRIEBSWELLE
WORM GEARBOXES WITH FREE INPUT SHAFT**

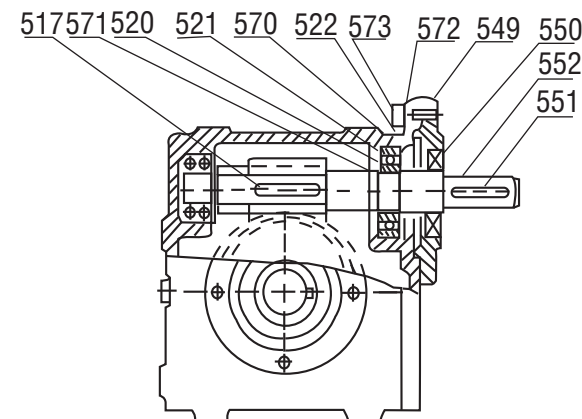

501.Delik mil	Hohlwelle	Hollow shaft
501. a-Çıkış mili	Abtriebswelle	Output shaft
501. b-Çıkış mili iki taraflı	Abtriebswelle,beidseitig	Output shaft,two sides
502.Yağ keçesi	Wellendichtring	Shaft seal
503.Rulman	Rillenkugellager	Grooved ball bearing
504.Kama	Passfader	Key
505.Salyangoz dişli	Schneckenrad	Worm well
506.Gövde	Schneckengetriebe-Gehäuse	Housing
507.Conta	IT-Oldichtung	Seal
508.Yağ tapası	Verschlusschraube	Locking screw
510.Havalandırma Civatası	Entlüftungsschruve	Vent screw
511.Pim	Kerbstift	Grooved pin
512.Gövde kapağı	Schneckengetriebe	Gear case cover
513.Burç	Distanzbuchse	Distance piece
514.Rulman	Rillenkugellager	Grooved ball bearing
515.Sekman	Sicherungsring	Circlip
516.Burç	Distanzbuchse	Distancepiece
517.Kama	Passfader	Key
518.Sonsuz Vida	Schnecke	Worm
520.Sekman	Sicherungsring	Circlip
521.Rulman	Rillenkugellager	Gooved ball bearing
522.Sekman	Sicherungsring	Circlip
532.Ayak plakası	Fussplatte	Base pelate
533.Flans	Flansch	Flange
534.Pim	Kerbstift	Grooved pin
536.Kama	Passfader	Key
537.Kapak	Verschlusskappe	Locking cap
539.Çevirme momenti tutucusu	Drehmomentstutze	Torque arm
549.Rulman yatağı	Antriebslager-Gehäuse	Input bearing housing
550.Yağ keçesi	Wellendichtring	Grower
551.Kama	Passfader	Key
552.Çalıştırıcı mil	Antriebswelle	Input shaft
555.Conta	Dichtug	Seal
558.Ayar pulu	Passschiebe	Shim
559.Imbus civata	Zylinderschraube	Socket head screw
560.Yağlı rondela	Federing	Grower
561.Altı köşe civata	Sechskanttschraube	Hexagon screw
562.Imbus civata	Zylinderschraube	Socket head screw
563.Ayar pulu	Passscheibe	Shim
564.Imbus civata	Zylinderschraube	Socket head screw
565.Pim	Kerbstift	Groved pin
566.Conta	Dichtug	Seal
570.Ayar pulu	Passscheibe	Shim
571.Ayar pulu	Passscheibe	Shim
572.Yağlı rondela	Federing	Grover
573.Altı köşe civata	Sechskanttschraube	Hexagon screw

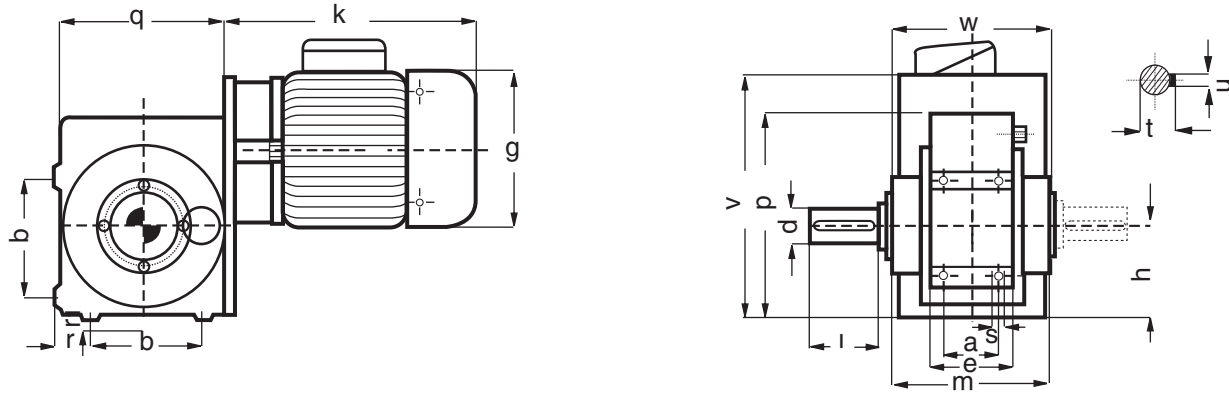

Tipi Typ Type	Bağlantı ölçüleri (Ayaklı + Flanşlı) Befestigungsmasse (Fuss + Flansch) Mounting dimensions (Foot + Flange)					Bağlantı ve hacim ölçüleri (Ayaklı + Flanşlı) Befestigungs-Raum-und Anschlussmasse (Fuss + Flansch) Outline and mounting, dimensions (Foot + Flange)						
	a	b	e	r	s	a ₁	b ₁	c ₁	e ₁	f ₁	s ₁	
TB 400-63	S-L	-	-	-	-	-	-	-	-	-	-	-
TB 400-71	S-L	45	55	63	25.5	M6	120	80	10	100	3	7
TB 530-63	S-L	-	-	-	-	-	-	-	-	-	-	-
TB 530-71	S-L	50	75	66	25.5	M8	140	95	10	115	3	9
TB 530-80	S-L	-	-	-	-	-	-	-	-	-	-	-
TB 652-71	S-L	-	-	-	-	-	-	-	-	-	-	-
TB 652-80	S-L	-	-	-	-	-	-	-	-	-	-	-
TB 652-90	S	55	100	74	30	M8	160	110	10	130	3.5	9
TB 652-90	L	-	-	-	-	-	-	-	-	-	-	-
TB 652-100	L	-	-	-	-	-	-	-	-	-	-	-

**SONSUZ VİDALI HELİS DİŞLİLİ
ÇİFT KADEMELİ MOTORLU REDÜKTÖR**

**Schnecken Stirnrad-getriebe motoren
universalbauform zweistufig**

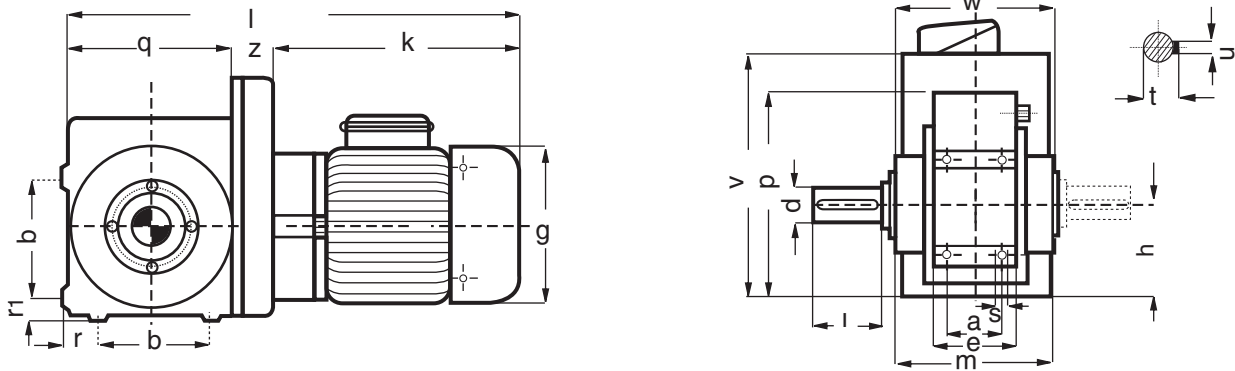

Tipi Typ Type	Bağlantı ölçüleri (Ayaklı + Flanşlı) Befestigungsmasse (Fuss + Flansch) Mounting dimensions (Foot + Flange)					Bağlantı ve hacim ölçüleri (Ayaklı + Flanşlı) Befestigungs-Raum-und Anschlussmasse (Fuss + Flansch) Outline and mounting, dimensions (Foot + Flange)						
	a	b	e	r	s	a ₁	b ₁	c ₁	e ₁	f ₁	s ₁	
TB 4000-63	S-L	-	-	-	-	-	-	-	-	-	-	-
TB 4000-71	S-L	45	55	63	25.5	M6	120	80	10	100	3	7
TB 5301-63	S-L	-	-	-	-	-	-	-	-	-	-	-
TB 5301-71	S-L	50	75	66	25.5	M8	140	95	10	115	3	9
TB 5301-80	S-L	-	-	-	-	-	-	-	-	-	-	-
TB 6520-71	S-L	-	-	-	-	-	-	-	-	-	-	-
TB 6520-80	S-L	-	-	-	-	-	-	-	-	-	-	-
TB 6520-90	S	55	100	74	30	M8	160	110	10	130	3.5	9
TB 6520-90	L	-	-	-	-	-	-	-	-	-	-	-
TB 6520-100	L	-	-	-	-	-	-	-	-	-	-	-

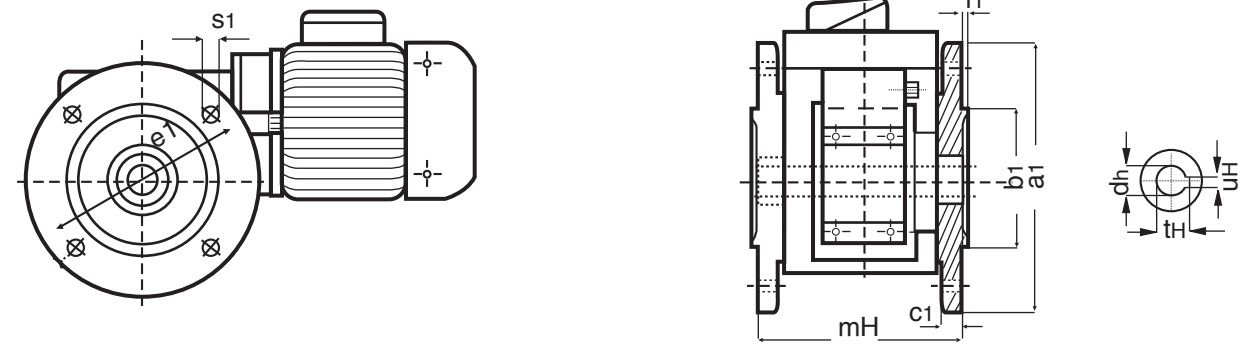

Bağlantı ölçüleri (Ayaklı + Flanşlı) Befestigungsmasse (Fuss + Flansch) Mounting dimensions (Foot + Flange)												Bağlantı ve hacim ölçüleri (Ayaklı + Flanşlı) Befestigungs-Raum-und Anschlussmasse (Fuss + Flansch) Outline and mounting, dimensions (Foot + Flange)				
q	k	g	v	w	m	p	h	d	l	t	u	d _h	u _h	t _h		
-	208	123	-	-	-	-	-	-	-	-	-	-	-	-		
105	220	141	139	104	108	129	52	20	40	22.8	6	20	6	22.8		
-	208	123	-	-	-	-	-	-	-	-	-	-	-	-		
154	220	141	170	109	119	154	63	25	50	28	8	20	6	22.8		
-	241	156	-	-	-	-	-	-	-	-	-	-	-	-		
-	222	123	-	-	-	-	-	-	-	-	-	-	-	-		
-	243	141	-	-	-	-	-	-	-	-	-	-	-	-		
150	260	156	212	134	138	185	80	30	60	33	8	28	8	31.3		
-	285	177	-	-	-	-	-	-	-	-	-	-	-	-		
-	318	177	-	-	-	-	-	-	-	-	-	-	-	-		

**SONSUZ VİDALI HELİS DİŞLİLİ
ÇİFT KADEMELİ MOTORLU REDÜKTÖR**

**Schnecken Stirnrad-getriebe motoren
universalbauform zweistufig**

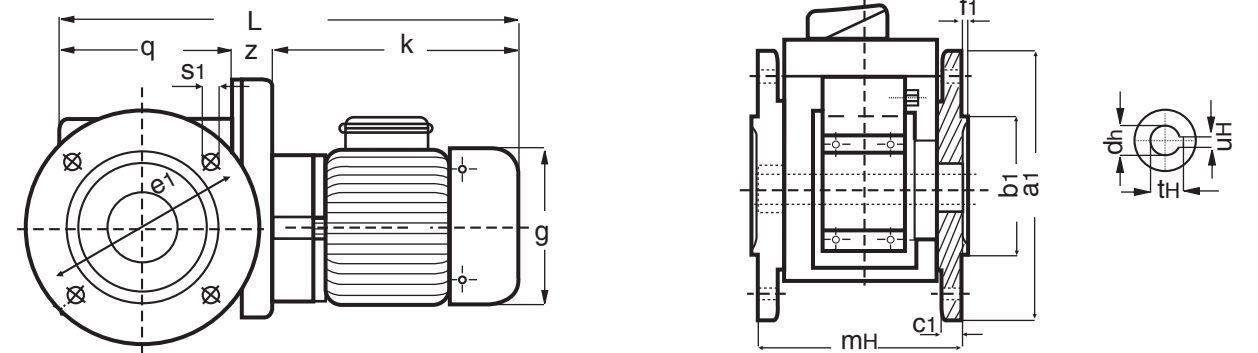

Bağlantı ölçüleri (Ayaklı + Flanşlı) Befestigungsmasse (Fuss + Flansch) Mounting dimensions (Foot + Flange)												Bağlantı ve hacim ölçüleri (Ayaklı + Flanşlı) Befestigungs-Raum-und Anschlussmasse (Fuss + Flansch) Outline and mounting, dimensions (Foot + Flange)						
q	k	g	v	w	m	p	h	d	l	t	u	d _h	u _h	t _h	L	z	m _h	
-	208	123	-	-	-	-	-	-	-	-	-	-	-	-	364	-	-	
105	220	141	139	104	108	129	52	20	40	22.8	6	20	6	22.8	376	51	124	
-	208	123	-	-	-	-	-	-	-	-	-	-	-	-	413	-	-	
154	220	141	170	109	119	154	63	25	50	28	8	20	6	22.8	425	51	136	
-	241	156	-	-	-	-	-	-	-	-	-	-	-	-	446	-	-	
-	222	123	-	-	-	-	-	-	-	-	-	-	-	-	525	-	-	
-	243	141	-	-	-	-	-	-	-	-	-	-	-	-	546	-	-	
150	260	156	212	134	138	185	80	30	60	33	8	28	8	31.3	563	52	155	
-	285	177	-	-	-	-	-	-	-	-	-	-	-	-	588	-	-	
-	318	177	-	-	-	-	-	-	-	-	-	-	-	-	620	-	-	

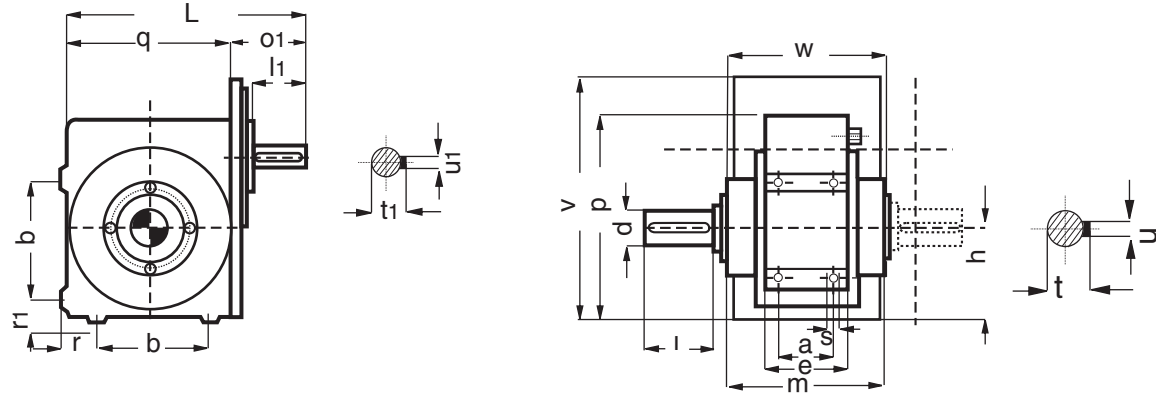

Tipi Typ Type	Bağlantı ölçüleri (Ayaklı + Flanşlı) Befestigungsmasse (Fuss + Flansch) Mounting dimensions (Foot + Flange)					Bağlantı ve hacim ölçüleri (Ayaklı + Flanşlı) Befestigungs-Raum-und Anschlussmasse (Fuss + Flansch) Outline and mounting, dimensions (Foot + Flange)										
	a	b	e	r	s	a ₁	b ₁	c ₁	e ₁	f ₁	s ₁	d ₁	l ₁	t ₁	u ₁	L
TB 400 W(T)	45	55	63	25.5	M6	120	80	10	100	3	7	11	23	12.5	4	149
TB 530 W(T)	50	75	66	25.5	M8	140	95	10	115	3	9	14	30	16	5	173
TB 652 W(T)	55	100	74	30	M8	160	110	10	130	3.5	9	19	40	21.3	6	225

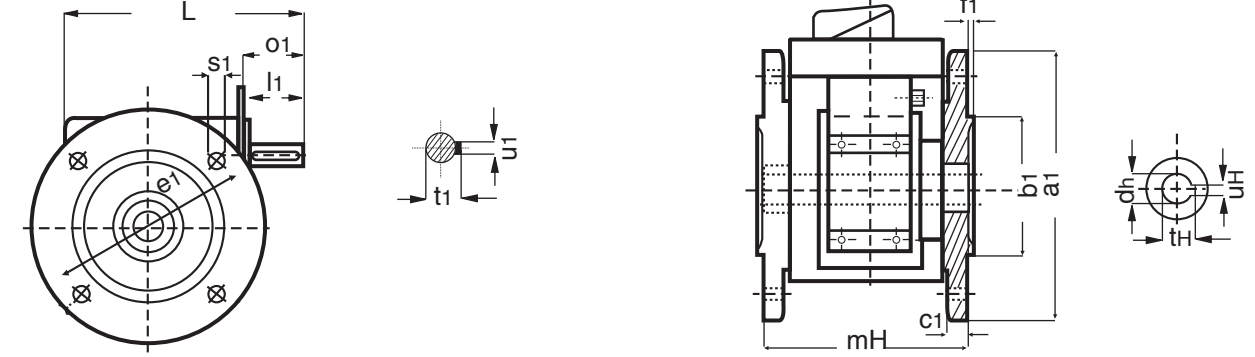

Tipi Typ Type	Bağlantı ölçüleri (Ayaklı + Flanşlı) Befestigungsmasse (Fuss + Flansch) Mounting dimensions (Foot + Flange)							Bağlantı ve hacim ölçüleri (Ayaklı + Flanşlı) Befestigungs-Raum-und Anschlussmasse (Fuss + Flansch) Outline and mounting, dimensions (Foot + Flange)							
	q	v	w	m	p	h	d	l	t	u	d _h	u _h	t _h	o ₁	
TB 400 W(T)	105	139	104	108	129	52	20	40	22.8	6	20	6	22.8	44	
TB 530 W(T)	154	170	109	119	154	63	25	50	28	8	20	6	22.8	51	
TB 652 W(T)	150	212	134	138	185	80	30	60	33	8	28	8	31.3	75	

**SONSUZ VİDALI ÇİFT KADEMELİ
W(T) TİPİ REDÜKTÖR**

**Schnecken getriebe mit
freier antriebswelle zweistufig**

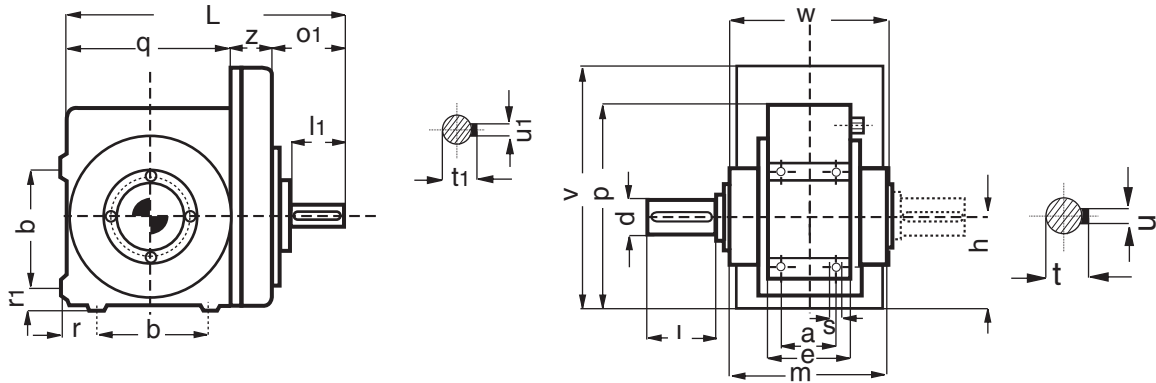

Tipi Typ Type	Bağlantı ölçüleri (Ayaklı + Flanşlı) Befestigungsmasse (Fuss + Flansch) Mounting dimensions (Foot + Flange)					Bağlantı ve hacim ölçüleri (Ayaklı + Flanşlı) Befestigungs-Raum-und Anschlussmasse (Fuss + Flansch) Outline and mounting, dimensions (Foot + Flange)										
	a	b	e	r	s	a ₁	b ₁	c ₁	e ₁	f ₁	s ₁	d ₁	l ₁	t ₁	u ₁	L
TB 4000 W(T)	45	55	63	25.5	M6	120	80	10	100	3	7	11	23	12.5	4	200
TB 5301 W(T)	50	75	66	25.5	M8	140	95	10	115	3	9	14	30	16	5	224
TB 6520 W(T)	55	100	74	30	M8	160	110	10	130	3.5	9	19	40	21.3	6	276

**SONSUZ VİDALI HELİS DİŞLİLİ
ÇİFT KADEMELİ W(T) TİPİ REDÜKTÖR**

**Schnecken Stirnrad-getriebe
mit freier Antriebswelle**

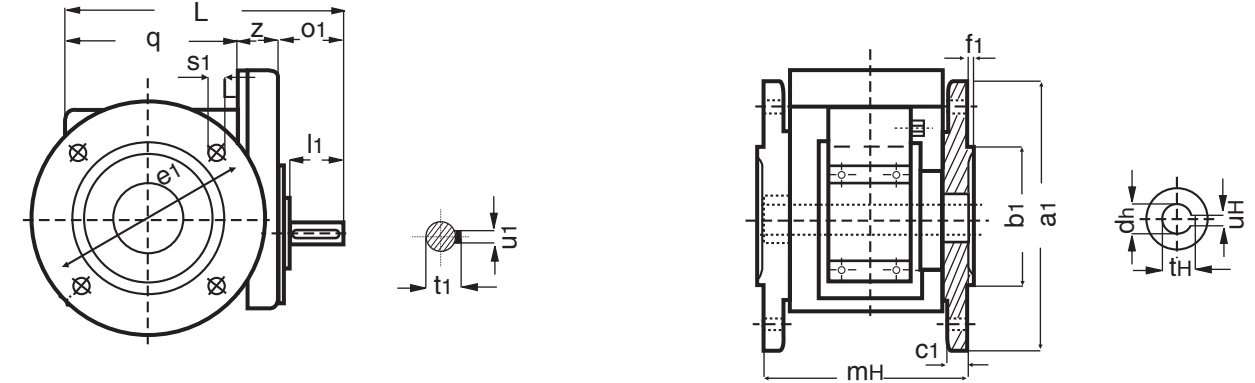

Tipi Typ Type	Bağlantı ölçüleri (Ayaklı + Flanşlı) Befestigungsmasse (Fuss + Flansch) Mounting dimensions (Foot + Flange)							Bağlantı ve hacim ölçüleri (Ayaklı + Flanşlı) Befestigungs-Raum-und Anschlussmasse (Fuss + Flansch) Outline and mounting, dimensions (Foot + Flange)							
	q	v	w	m	p	h	d	l	t	u	d _h	u _h	t _h	o ₁	z
TB 4000 W(T)	105	139	104	108	129	52	20	40	22.8	6	20	6	22.8	44	51
TB 5301 W(T)	154	170	109	119	154	63	25	50	28	8	20	6	22.8	51	51
TB 6520 W(T)	150	212	134	138	185	80	30	60	33	8	28	8	31.3	75	52

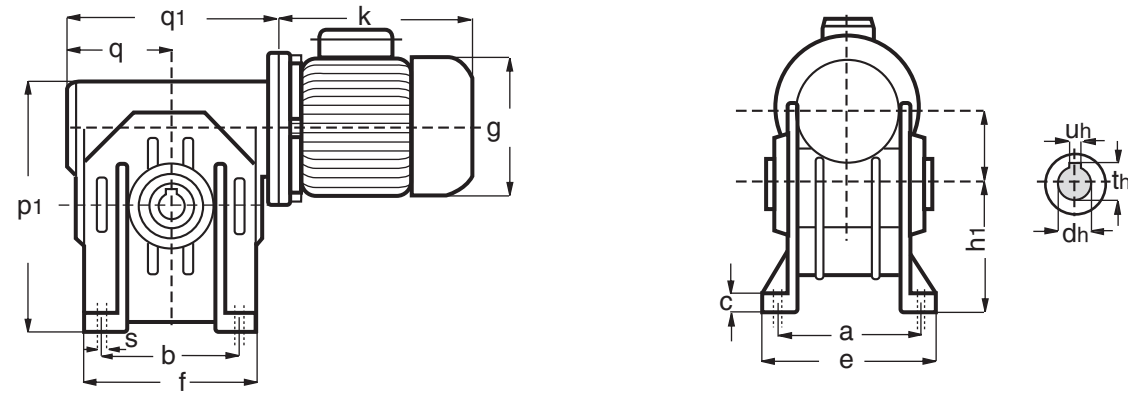

Tipi Typ Type	Bağlantı ölçüleri (Ayaklı + Flanşlı) Befestigungsmasse (Fuss + Flansch) Mounting dimensions (Foot + Flange)							Bağlantı ve hacim ölçüleri (Ayaklı + Flanşlı) Befestigungs-Raum und Anschlussmasse (Fuss + Flansch) Outline and mounting, dimensions (Foot + Flange)							
	a	b	c	e	f	s	g	h	h ₁	k	m	p ₁	q	q ₁	w
TB 550 / 71 S-L	105	80	10	132	110	9	141	90	60	220	98	160	70	155	85
TB 750 / 71 S-L							141			220					
TB 750 / 80 S-L	115	120	15	144	158	11	156	115	79	233	121	191	89	187	106
TB 750 / 90 S-L							177			250					
TB 950 / 80 S-L							156			233					
TB 950 / 90 S-L	164	160	15	196	210	13	177	150	121	275	150	271	124	250	147
TB 950 / 100 L							198			308					
TB 110 / 90 L							177			250					
TB 110 / 100 L	180	200	15	220	270	13	198	170	140	308	155	321	144	293	170
TB 110 / 112 L							220			322					
TB 130 / 90 L							177			275					
TB 130 / 100 L	190	240	18	244	282	15	198	200	155	308	190	363	160	323	194
TB 130 / 112 L															
TB 1050 / 100 L							198			308					
TB 1050 / 112 L	220	280	20	260	334	19	220	240	182	322	220	422	190	382	225
TB 1050 / 132 S							260			363					

**SONSUZ VİDALI TEK KADEMELİ
W(T) TİPİ REDÜKTÖR**

**Schnecken getriebe mit
freier antriebswelle**

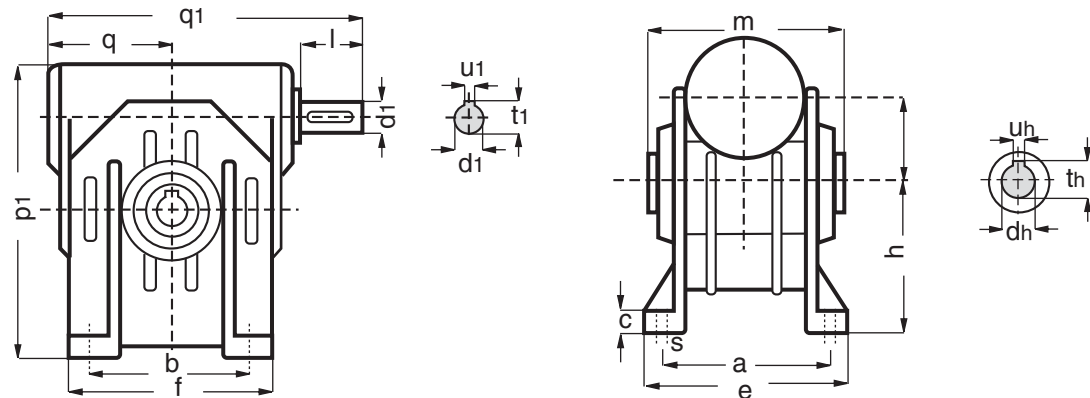

Tipi Typ Type	Bağlantı ölçüleri (Ayaklı + Flanşlı) Befestigungsmasse (Fuss + Flansch) Mounting dimensions (Foot + Flange)							Bağlantı ve hacim ölçüleri (Ayaklı + Flanşlı) Befestigungs-Raum und Anschlussmasse (Fuss + Flansch) Outline and mounting, dimensions (Foot + Flange)						
	a	b	c	e	f	s	h	h ₁	m	p ₁	q	q ₁	w	
TB 550 T	105	80	10	132	110	9	90	60	98	160	70	155	85	
TB 750 T	115	120	15	144	158	11	115	79	121	191	89	187	106	
TB 950 T	164	160	15	196	210	13	150	121	150	271	124	250	147	
TB 110 T	180	200	15	220	270	13	170	140	155	321	144	293	170	
TB 130 T	190	240	18	244	282	15	200	155	190	363	160	323	194	
TB 1050 T	220	280	20	260	334	19	240	182	220	422	190	382	225	

Worm geared motors

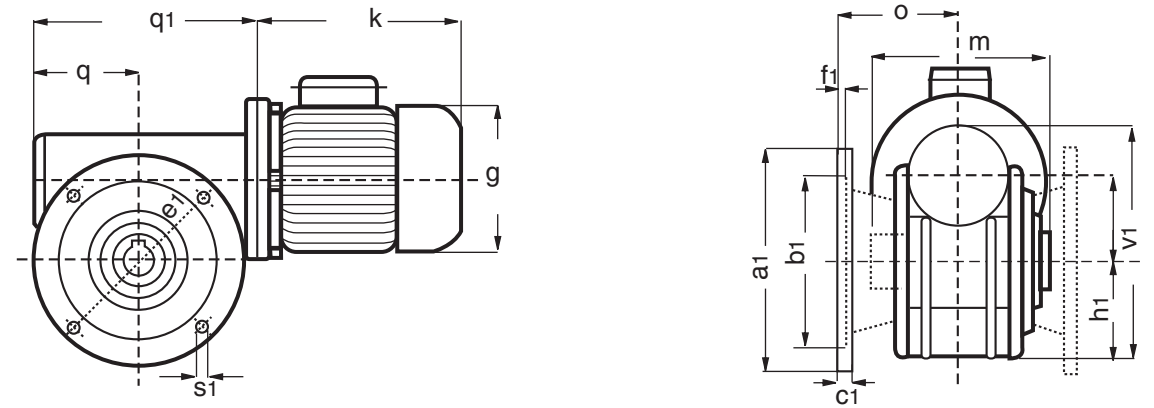

Tipi Typ Type	Bağlantı ölçüleri (Ayaklı + Flanşlı) Befestigungsmasse (Fuss + Flansch) Mounting dimensions (Foot + Flange)							Bağlantı ve hacim ölçüleri (Ayaklı + Flanşlı) Befestigungs-Raum und Anschlussmasse (Fuss + Flansch) Outline and mounting, dimensions (Foot + Flange)			
	a ₁	b ₁	c ₁	e ₁	f ₁	s ₁	0	d _h	t _h	u _h	
	155	110	14	130	5	M8	92	24	26.7	8	
	190	140	12	165	5	11	88	28	31.1	8	
	250	180	14	215	5	13	127	38	41.7	10	
	250	180	18	215	5	15	150	42	45.7	12	
	300	230	18	265	5	15	150	48	52.2	14	
	350	250	20	300	6	19	175	55	60.2	16	

Worm gearboxes

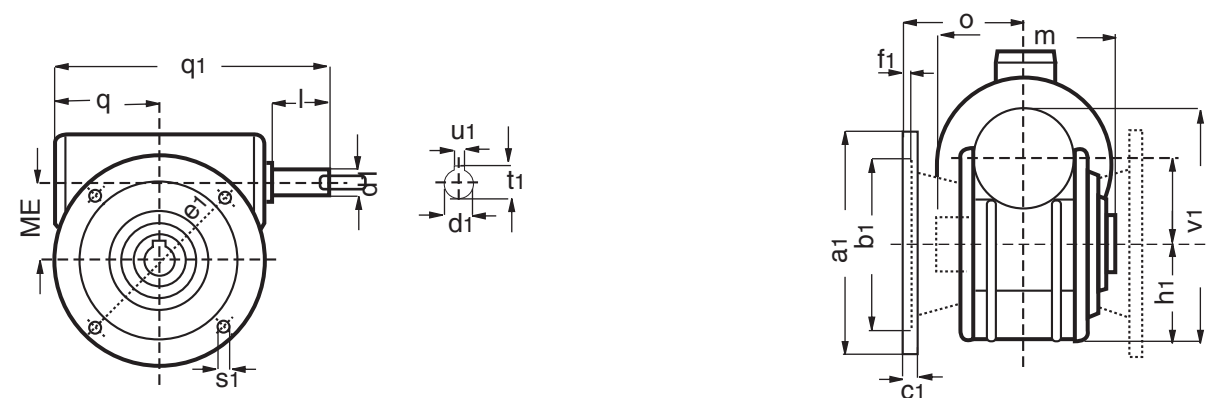

Tipi Typ Type	Bağlantı ölçüleri (Ayaklı + Flanşlı) Befestigungsmasse (Fuss + Flansch) Mounting dimensions (Foot + Flange)							Bağlantı ve hacim ölçüleri (Ayaklı + Flanşlı) Befestigungs-Raum und Anschlussmasse (Fuss + Flansch) Outline and mounting, dimensions (Foot + Flange)						
	a ₁	b ₁	c ₁	e ₁	f ₁	s ₁	0	d _h	t _h	u _h	d ₁	l ₁	t ₁	u ₁
	155	110	14	130	5	M8	92	24	26.7	8	14	30	16	5
	190	140	12	165	5	11	88	28	31.1	8	19	40	21.5	6
	250	180	14	215	5	13	127	38	41.7	10	24	50	27	8
	250	180	18	215	5	15	150	42	45.7	12	32	80	35	10
	300	230	18	265	5	15	150	48	52.2	14	38	80	41.5	10
	350	250	20	300	6	19	175	55	60.2	16	42	110	45.2	12

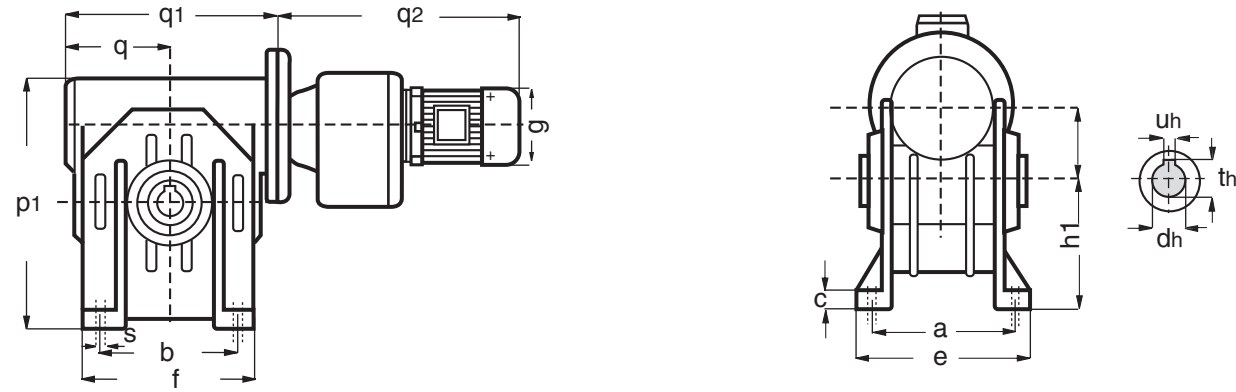

Tipi	Bağlantı ölçüleri (Ayaklı + Flanşlı)	Bağlantı ve hacim ölçüleri (Ayaklı + Flanşlı)
Typ	Befestigungsmasse (Fuss + Flansch)	Befestigungs-Raum und Anschlussmasse (Fuss + Flansch)
Type	Mounting dimensions (Foot + Flange)	Outline and mounting, dimensions (Foot + Flange)

	a	b	c	e	f	s	g	h	h ₁	k	m	p ₁	q	q ₁	q ₂	w
TB 750 / 01-71 S-L	115	120	15	144	158	11	156	115	79	233	121	191	89	187	325	106
TB 950 / 20 - 80 S-L	164	160	15	196	210	13	177	150	121	275	150	271	124	250	367	147
TB 110 / 20 - 90 S-L	180	200	15	220	270	13	198	170	140	308	155	321	144	293	383	170
TB 130 / 30 -90 S-L	190	240	18	244	282	15	198	200	155	308	190	363	160	323	399	194
TB 1050 / 33-100 L	220	280	20	260	334	19	220	240	182	322	220	422	190	382	478	225

**SONSUZ VİDALI + HELİS DİŞLİLİ
W(T) TİPİ REDÜKTÖR**

**Stirrad + Schnecken getriebe
mit freier antriebswelle**

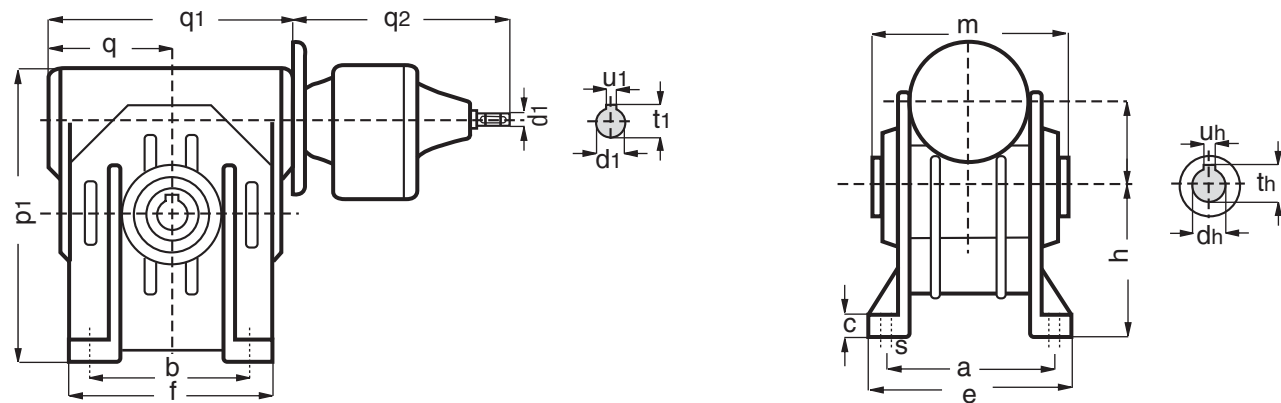

Tipi	Bağlantı ölçüleri (Ayaklı + Flanşlı)	Bağlantı ve hacim ölçüleri (Ayaklı + Flanşlı)
Typ	Befestigungsmasse (Fuss + Flansch)	Befestigungs-Raum-und Anschlussmasse (Fuss + Flansch)
Type	Mounting dimensions (Foot + Flange)	Outline and mounting, dimensions (Foot + Flange)

	a	b	c	e	f	s	q ₂	h	h ₁	m	p ₁	q	q ₁	w
TB 750-01 T	115	120	15	144	158	11	205	115	79	121	191	89	187	106
TB 950-20 T	164	160	15	196	210	13	253	150	121	150	271	124	250	147
TB 110-20 T	180	200	15	220	270	13	253	170	140	155	321	144	293	170
TB 130-30 T	190	240	18	244	282	15	380	200	155	190	363	160	323	194
TB 1050-33 T	220	280	20	260	334	19	357	240	182	220	422	190	382	225

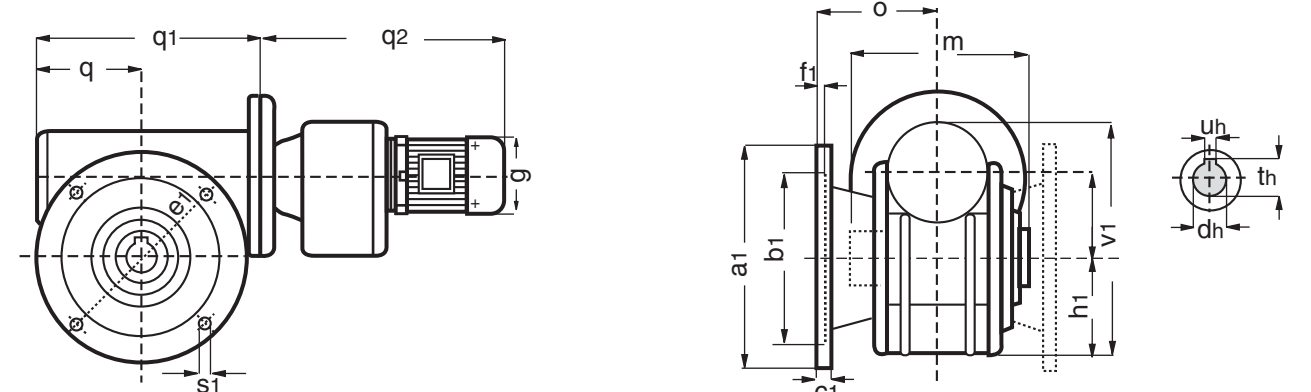

Tipi	Bağlantı ölçüleri (Ayaklı + Flanşlı)	Bağlantı ve hacim ölçüleri (Ayaklı + Flanşlı)
Typ	Befestigungsmasse (Fuss + Flansch)	Befestigungs-Raum und Anschlussmasse (Fuss + Flansch)
Type	Mounting dimensions (Foot + Flange)	Outline and mounting, dimensions (Foot + Flange)

	a ₁	b ₁	c ₁	e ₁	f ₁	s ₁	0	d _h	t _h	u _h
	190	140	12	165	5	11	88	28	31.1	8
	250	180	14	215	5	13	127	38	41.7	10
	250	180	18	215	5	15	150	42	45.7	12
	300	230	18	265	5	15	150	48	52.2	14
	350	250	20	300	6	19	175	55	60.2	16

**Helical Worm Gearboxes
with free input shaft**

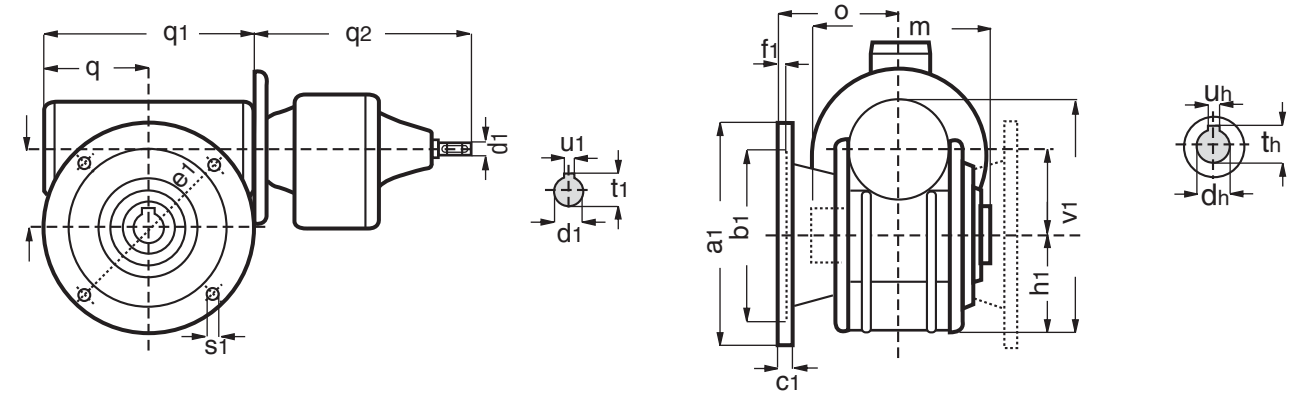

Tipi	Bağlantı ölçüleri (Ayaklı + Flanşlı)	Bağlantı ve hacim ölçüleri (Ayaklı + Flanşlı)
Typ	Befestigungsmasse (Fuss + Flansch)	Befestigungs-Raum-und Anschlussmasse (Fuss + Flansch)
Type	Mounting dimensions (Foot + Flange)	Outline and mounting, dimensions (Foot + Flange)

	a ₁	b ₁	c ₁	e ₁	f ₁	s ₁	0	d _h	t _h	u _h	d ₁	l ₁	t ₁	u ₁
	190	140	12	165	5	11	88	28	31.1	8	14	30	16	5
	250	180	14	215	5	13	127	38	41.7	10	19	40	21.5	6
	250	180	18	215	5	15	150	42	45.7	12	19	40	21.5	6
	300	230	18	265	5	15	150	48	52.2	14	24	50	27	8
	350	250	20	300	6	19	175	55	60.2	16	32	80	35	10

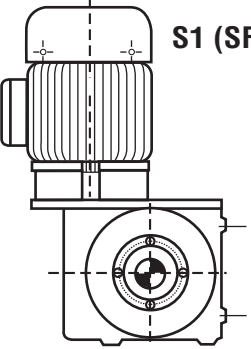
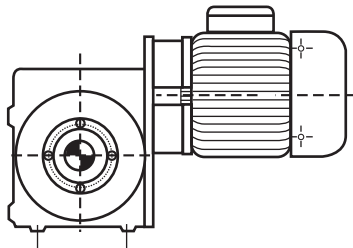
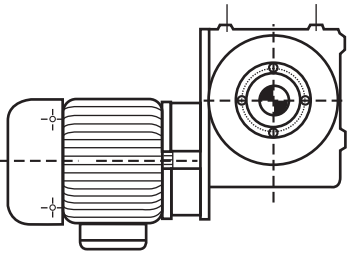
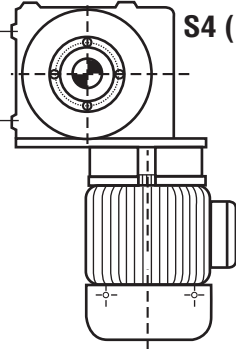
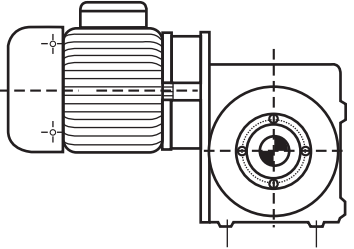
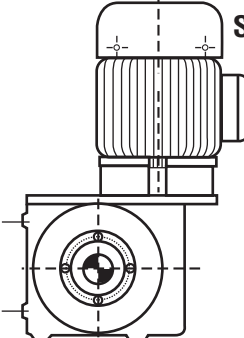
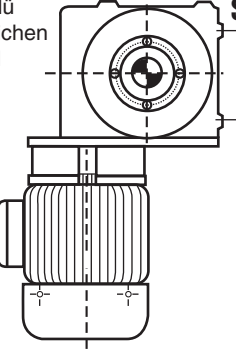
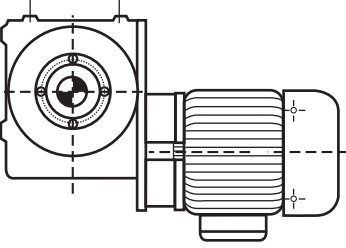
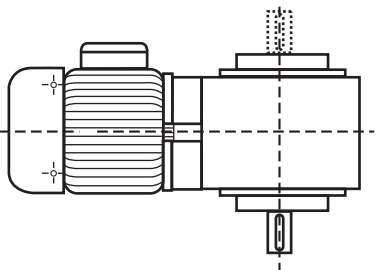
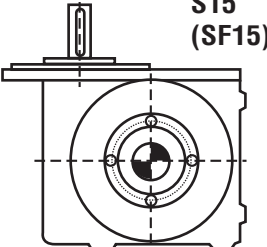
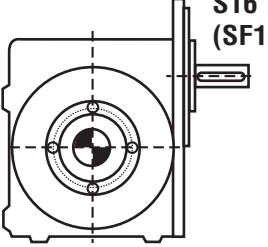
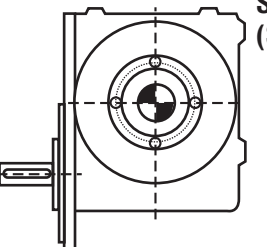
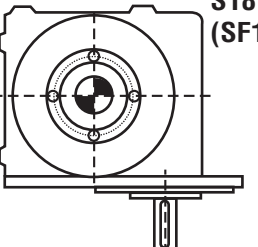
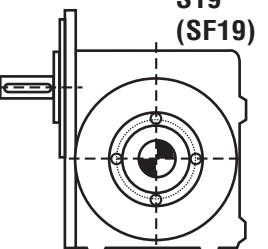
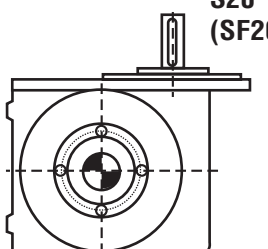
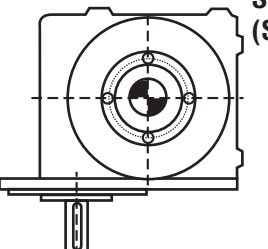
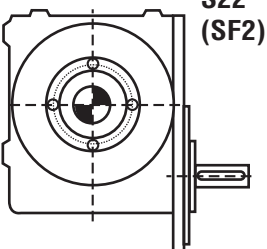
<p>Sembolü Kurzezeichen Symbol</p>  <p>S1 (SF1)</p>	 <p>S2 (SF2)</p>	 <p>S3 (SF3)</p>	
<p>Sembolü Kurzezeichen Symbol</p>  <p>S4 (SF4)</p>	 <p>S5 (SF5)</p>	 <p>S6 (SF6)</p>	
<p>Sembolü Kurzezeichen Symbol</p>  <p>S7 (SF7)</p>	 <p>S8 (SF8)</p>	 <p>S9 (SF9)</p>	
 <p>S15 (SF15)</p>	 <p>S16 (SF16)</p>	 <p>S17 (SF17)</p>	 <p>S18 (SF18)</p>
 <p>S19 (SF19)</p>	 <p>S20 (SF20)</p>	 <p>S21 (SF21)</p>	 <p>S22 (SF22)</p>